

Fall 2018

PARKWAY



TODAY

News and Information for Residents of Parkway Schools

“Every student has a story.”



With the help of a robotics kit, third grade student Brennen is engineering his way through a real-world problem, thanks to Parkway's new science curriculum.

Science: Growing Beyond the Basics

Every child has a story. Every child has something that connects them to school in some way. For Brennen, that happens to be robotics.

It wasn't too long ago that Brennen, a third grader at Bellerive Elementary, struggled to relate socially to peers in his special education classroom. Earlier this year, he was surprised with a robotics kit to share with his classmates after curriculum coordinator, Jennifer Abdel-Azim, realized Brennen's passion for robots. As the VEX IQ robotics kit was delivered, Brennen's eyes lit up. He immediately opened the kit and started connecting the small building blocks, shafts and gears together and linked them to his video game-like controller.

"It was in that moment, when I met Brennen, that I realized this is really good for kids," Abdel-Azim said. "This is something that will connect Brennen to his classmates and he can teach them as well."

This story isn't unique to Brennen. This year, Parkway redesigned its elementary science curriculum and adopted a new hands-on, project based, collaborative learning experience to expand student thinking beyond basic concepts.

"These days, kids can Google anything. So do we want them to spend time just memorizing facts?" Abdel-Azim said. "We need to go beyond the basics to give them opportunities to invent, design, create and build. We want them to learn to fail — to build something that doesn't work and then learn from that."

Parkway partnered with Washington University's MySci program and Project Lead the Way to offer the new science experiences, becoming the largest district to implement this type of curriculum for every student in every grade. Science, Technology, Engineering and Math (STEM) projects include designing simple algorithms and implementing them digitally onto a tablet in kindergarten to working as a team to examine the hydrosphere which explores the distribution of water on Earth in fifth grade.

Projects and experiences are designed to develop the skills of Parkway students in areas considered essential in the 21st century — critical thinking, creativity, communication and collaboration. Projects often start with a question or a problem then students are responsible for working through them in small groups to solve problems and present their ideas.

According to the World Economic Forum, 65 percent of children entering kindergarten today will end up working in jobs and careers that don't exist in 2018.

"In order for our students to be successful in the real world, they have to be problem solvers, they have to be collaborators and they have to know how to communicate and test ideas," Abdel-Azim said. "That's what colleges are telling us and our business community is telling us. We want our students to be able to do that when they leave Parkway."

Who knows, maybe Brennen will lead a team that designs the new robot of the future.



Brennen, celebrating while building his robot

Experiences by Grade

K

Students use the design process to design, build, test, and reflect on a model that can move a heavy object up a ramp using pushes and/or pulls.

1st

Students will analyze media to determine the peak time during the day for UV radiation and then design a cover for a playground structure.

2nd

Students will design an insulating cover for an ice pop to prevent melting.

3rd

After learning about different types of severe weather, students design and build a levee that can withstand a flood.

4th

After students have explored energy conversion and transfer, they are presented with a design problem involving moving large amounts of donated food from a truck to a food pantry.

5th

Students will work with a group to design, model and test a robot that can remove hazardous material from a disaster site.

PARKWAY AT A GLANCE



ELEVEN NATIONAL SCHOOLS OF CHARACTER
NATIONAL SCHOOL DISTRICT OF CHARACTER

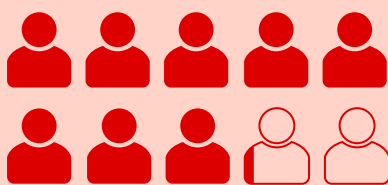
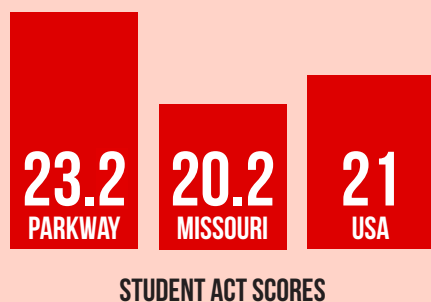

81.5% OF PARKWAY TEACHERS HAVE A
MASTER'S DEGREE OR ABOVE
(58.6% STATE AVERAGE)



17 NATIONAL BLUE RIBBON SCHOOLS

High Schools Ranked Top in Missouri

All four Parkway high schools are among the best public schools in Missouri according to Niche.com. All four high schools rank in the top 20 high schools in the state. The Best Public High Schools ranking is based on rigorous analysis of key statistics and millions of reviews from students and parents using data from the U.S. Department of Education. Ranking factors include state test scores, college readiness, graduation rates, SAT/ACT scores, teacher quality and high school ratings.



Best Communities for Music Education

Parkway Schools has been honored with the Best Communities for Music Education designation from The National Association of Music Merchants Foundation for its outstanding commitment to music education. Parkway is one of five districts in Missouri to receive this designation. The Best Communities for Music Education designation is awarded to districts that demonstrate outstanding achievement in efforts to provide music access and education to all students. Parkway believes that music education helps students develop educational, cognitive and social skills.



Brian Reeves, choral director at North High, shared, what initially attracted him to teach music in Parkway. "In Parkway, every third grade student learns to play the violin as part of the Strings Program. That's remarkable! The first time I heard of this was as a new teacher working on the west side of the state. I knew then, that I wanted to teach and live in Parkway."



Parkway believes that music and the arts are important elements of a well-rounded education for all children. Parkway's Jeff Lackey, coordinator of fine arts, spoke to the benefits of students making music: "What we do in the music room is real-world experience. Music education lays the foundation for excellence in collaborative settings, creative problem solving and the student has to adapt and adjust to situations. Our students are working together to meet a common goal while helping each other be better than they were the day before."

"Parkway has a long-standing tradition of music and fine-arts program support from students, parents and the community at large," Lackey went on to say, "That level of support is unique to our school district. It allows us to offer opportunities to any student with the desire and commitment to learn. We have been doing things well for a long time and the strong interest and support has contributed to our success."



"As leaders, its easy for us to think about how we can improve upon things," he continued, "but it does feel good to take a step back, and be recognized for our hard work and our students' achievements."

Forbes Magazine Recognizes Parkway

FORBES BEST EMPLOYERS FOR WOMEN 2018



P

arkway Schools has been selected as one of “America’s Best Mid-Size Employers 2018” by *Forbes Magazine*. Of those employers recognized by *Forbes*, Parkway ranked as the second highest school district (K-12) in the nation and it ranked as the third highest employer among all industries.

The evaluation for “America’s Best Employers” is based on surveys from 30,000 employees at companies with at least 1,000 people. In total, 1,000 employers have been awarded. Only seven K-12 school districts in the country were recognized.

Forbes Magazine has also named Parkway Schools as one of “America’s Best Employers for Women.”

“Parkway is proud of its record when it comes to supporting our female workforce,” says Amy Joyce, Parkway’s chief human resources officer. “Pay equity, opportunities for advancement, family leave and support for health and wellness are among the many things the district has done well in this regard.”

Forbes partnered with market research company Statista to identify the companies that have proven themselves as America’s best employers for women. To determine the list, Statista surveyed 40,000 Americans, including 25,000 women, working for businesses with at least 1,000 employees. All the surveys were anonymous, allowing participants to openly share their opinions.

Parkway Named Top St. Louis Workplace

For the fifth year in a row, Parkway was named a top workplace by the *St. Louis Post-Dispatch*. Parkway ranked #21 on the list of 150 top workplaces in St. Louis in the large company category. Several aspects of workplace culture were measured, including values, encouraging new ideas, meaningful work, employees feeling appreciated and engaged management.

With nearly 2,600 employees, Parkway is one of the largest employers in Chesterfield and St. Louis County.

PARKWAY AT A GLANCE

\$68,307

AVERAGE TEACHER SALARY
(\$49,763 STATE AVERAGE)

AAA

PARKWAY’S BONDS ARE RATED AAA
BY STANDARD & POOR’S AND ARE AMONG ONLY
FOUR SCHOOL DISTRICTS IN THE STATE TO
RECEIVE THE HIGHEST RATING

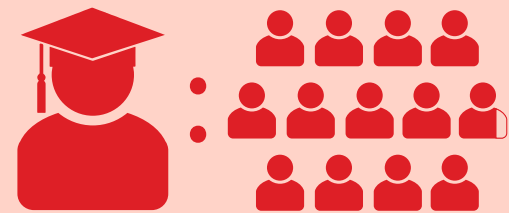

12.8 STUDENT TO CERTIFIED STAFF RATIO



NATIONAL MERIT SCHOLARS 2018

class acts

Colts Race Toward State Championships



Central High Boys Volleyball becoming state champions



Central High was awarded the Commissioner's Cup, signifying overall improvement and excellence in Suburban and Missouri State High School Activities Association sponsored championships. Across all sports, the Colts won six district championships, 10 conference championships and appeared in five final fours in state tournaments.

Central High's boys soccer team became Class 3 state champions last fall. The Colts defeated Washington in the championship game 1-0, making it the first state championship achieved by the boys varsity team in school history. The team finished 21-8-1 on the year and is coached by Brian Adam.

Last spring, the boys volleyball team swept St. Mary's 25-20, 27-25, to become Class 3 state champions for a second year in a row. The team finished 31-6 on the year, and has won three state championships during head coach Tom Schaefer's 23 years with the team.

STARS Award-winning Researchers



Ten Parkway students recently completed the Students and Teachers as Research Scientists (STARS) summer program at the University of Missouri-St. Louis. STARS is a six-week summer program that pairs talented rising senior high school students and new undergraduate students with more than 60 local scientists in the fields of biology, chemistry, computer science, earth science, engineering, environmental science, mathematics, medicine, physics and psychology.

The mentors are top researchers from partner institutions that include Confluence Discovery Technologies, the Donald Danforth Plant Science Center, Saint Louis University, Washington University in St. Louis and the host institution, University of Missouri-St. Louis.

Central High
Haoyuan Chen
Divya Minnaganti
Yerin Moon

North High
Meher Arora
Rubina Thomas

South High
Neha Potta
Vedha Srigiri

West High
Matthew Boyd
Nina Maitra
Shahzan Mian

Acing the ACT

Of the millions of students who take the ACT each year, less than one tenth of one percent earn the top score. Seven Parkway students achieved a perfect score on the ACT college admission exam this year. The test is scored on a scale of 1-36, and a student's composite score is the average of the four test scores in English, mathematics, reading and science.



Paden Davis, West High
Paden plays baseball for West and the Adidas Surge and is involved in the school's robotics club. Paden is considering MIT and Georgia Tech.

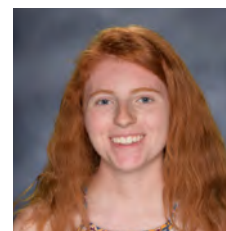

Nell Jaskowiak, West High
Nell is the captain of the color guard and plays in the orchestra. Nell is looking at several universities and wants to study classics and environmental sciences.

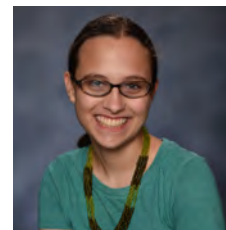

Emily Linn, South High
Emily plays in the orchestra and is involved in the National Honor Society, Beta Chi Pi, Scholar Bowl and Mu Alpha Theta. She also volunteers in her spare time.

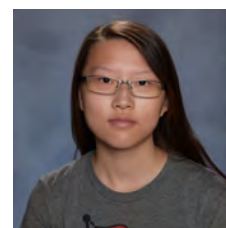

Hannah Maher, North High
Hannah enjoys cooking and reading. She is considering the University of Chicago and Loyola where she plans to study environmental science, psychology or biology.



Emma Parker, South High
Emma serves as section leader in the marching band and she plays tenor and alto saxophone. She is considering the University of Missouri's Honors College and the University of Kansas.



Natan Shpringman, West High
Natan enjoys drawing and painting. She is considering Dartmouth College and Harvey Mudd College where she plans to study biomedical engineering.



Rachel Wang, West High
Rachel plans to study economics or business with a second major or minor in history or cultural anthropology.



PROPOSITION S: WILL NOT INCREASE TAX RATE

Dear Parkway Resident,

As superintendent of Parkway Schools, it is my responsibility to provide you with information about our schools. Whether you have children in Parkway or in private schools, are new to the area or are a long-time resident, this information will be important to you.



**Superintendent
Keith Marty**

For more than 60 years, Parkway has served this community by providing public schools where students meet or exceed state and national standards. Parkway has over 75,000 proud alumni who have benefitted from quality schools.

As you may be aware, public school districts rely on bond issues to pay for major maintenance and repair projects in schools as they age. Recently, the school board voted unanimously to place a \$110 million bond issue on the Nov. 6 ballot.

At several meetings held over the past year, community members helped prioritize needs in our school buildings and I'm confident that they have developed a list of priorities and projects which will keep our Parkway schools safe and secure, up-to-date and prepare our students for an ever-changing world.

The purpose of this insert is to provide you with information that will allow you to make an informed decision. For more information, visit our website at ParkwaySchools.net. We encourage you to vote on Nov. 6.

Sincerely,

Keith Marty, Ed.D.
Superintendent

FUNDING PRIORITIES IDENTIFIED BY OUR COMMUNITY



**Safety &
Security**



**Maintenance &
Repairs**



**Renovations &
Additions**



Technology

Proposition

S



PROPOSITION S: WILL NOT INCREASE TAX RATE

What would Proposition S fund?

\$109,998,680

PROPOSITION S



Safety and Security • \$12,545,655

Our community has identified school safety and security as a top priority. The bond issue would fund security improvements, including double-entry door vestibules providing a more secure entry into our schools; additional intruder-resistant safety film to secondary entrances and windows; double the number of security cameras at every elementary school; and adding new, updated fire sprinklers across the district.

Another large security project planned is installing new locks in gyms and large spaces so the doors lock from the inside. The bond issue will also focus on adding walls and classroom doors to improve lockdown security and the classroom learning environment at three remaining open concept schools in Parkway.



Basic Maintenance & Repairs • \$57,779,361

When you combine all of our schools together, Parkway operates and maintains over 3.5 million square feet of facilities. This is like maintaining nearly three Busch Stadiums. On the back page of this insert, you will see the full project list that include items like replacing old heating, ventilation and air conditioning units and leaky, old roofs across the district. The bond issue also would allow replacement of old parking lots and sidewalks at schools across the district.

Classroom, Restroom, Library, Health and other Renovations/Additions • \$31,673,664

Funds from this bond issue would allow for renovations to libraries in Parkway middle schools. Another large project is converting the Instructional Services Center to a McKelvey primary school to address overcrowding, as well as continuing phase two of the North High School master plan.



Technology Updates • \$8,000,000

Funds from the bond issue would allow for classrooms to be upgraded from 12-year-old smart boards to flat-panel collaborative boards, allowing for greater teamwork and flexibility in the classroom.



*Damaged and aged door locks
South Middle*



*Fractured pavement
McKelvey Elementary*



*Example of
double-entry vestibule*



*Rusted water boiler
Mason Ridge Elementary*



How can we complete these projects without raising taxes?

Each year, Parkway pays off old debt from previous bonds. As our loan balance decreases, we are able to borrow more money and pay it back using revenue from the existing tax rate.



If Prop S does not pass, will our tax rate go down?

Not for several years. As old bonds continue to be paid off, however, the tax rate would eventually be reduced unless voters approved another bond issue.



What would happen if it does not pass?

Some maintenance and repair work would have to be deferred and most school renovation projects would be postponed indefinitely. The most critical maintenance and repair needs would still have to be addressed, and additional classrooms will be needed to address overcrowding in the McKelvey area. To pay for this, more money would have to be spent from the day-to-day operating budget (the part that normally pays for classroom instruction, teachers, staff and supplies).



Why is this being proposed?

Parkway has more than 3.5 million square feet of school facilities with a replacement value of more than \$875 million. The average age of a Parkway school is 50 years. These buildings are well-constructed, but require ongoing maintenance, repair and renovation just like our homes. Parkway has a responsibility to ensure these facilities are properly maintained for future generations of students.



How do schools use bond issues to benefit students?

Bond issues allow schools to pay for costly repairs and renovation over time instead of having to pay all at once. They also allow schools to devote most of their day-to-day operating budgets for classroom instruction instead of major repair work.



How will the funds be used?

If approved, each summer for the next four years (2019-2022), funds would be allocated for major categories identified: safety and security updates; ongoing maintenance, repairs and renovations to keep aging schools up-to-date; additions and renovations of classroom instructional spaces; and technology upgrades.

The average Parkway school is now 50 years old. Most of our schools were built between 1963 and 1971.

VOTER INFORMATION

Election Day

Tuesday, Nov. 6

Polls will be open 6 a.m.-7 p.m.

How to vote absentee

Absentee ballots are available at stlouisco.com. Absentee ballot requests may be made in writing by Oct. 31 from the Board of Election Commissioners, 725 Northwest Plaza Drive, St. Ann, MO 63074.

OFFICIAL BALLOT

PROPOSITION S PARKWAY SCHOOL DISTRICT, ST. LOUIS COUNTY, MO TUESDAY, NOVEMBER 6, 2018

Shall the Parkway School District borrow money in the amount of One Hundred Ten Million Dollars (\$110,000,000) and issue general obligation bonds for the payment thereof, resulting in no estimated increase to the debt service property tax levy, for the purpose of improving school safety and security and maintaining, repairing, improving, furnishing and equipping school facilities and sites, including but not limited to constructing additions to existing school buildings, roof and site repairs, and HVAC, plumbing, electrical and technology upgrades throughout the District? If this proposition is approved, the adjusted debt service levy of the school district is estimated to remain unchanged at \$0.49 per one hundred dollars assessed valuation of real and personal property. The authorization of the Bonds will authorize the levy and collection of an annual tax in addition to the other taxes provided for by law on all taxable tangible property in the District sufficient to pay the interest and principal of the Bonds as they fall due.



PROPOSITION S: WILL NOT INCREASE TAX RATE

BARRETTS ELEMENTARY

Replace three rooftop HVAC units
Replace one HVAC unit ventilator
Replace nine roof sections
Replace driveway to Dougherty Ferry Rd south of school
Replace two sidewalks

BELLERIVE ELEMENTARY

Replace main electrical switchboard
Create walls extending to ceiling to secure classrooms in pods 1500, 1600 and 1700
Modify HVAC system for pods 1500, 1600 and 1700

CARMAN TRAILS ELEMENTARY

Replace one rooftop HVAC unit
Replace one electrical transformer
Replace parking lots on south side of school

CLAYMONT ELEMENTARY

Replace one rooftop exhaust fan
Replace main water line
Replace parking lot and driveway east of school
Replace exterior stairs leading to playground and north side of building
Replace two sidewalks

CRAIG ELEMENTARY

Replace five rooftop exhaust fans
Replace one rooftop HVAC unit
Replace one roof section
Replace two skylights with Solatubes
Replace parking lot in front of building
Replace paved play area behind school leading to main playground

EARLY CHILDHOOD CENTER

Replace two rooftop exhaust fans
Replace two hot water boilers and four pumps
Replace electrical panelboard
Replace two electrical transformers
Replace two roof mounted exhausts
Renovate nurse's office/health area
Replace wood retaining wall on east side of the building
Install fire sprinklers in the entire building
Replace main parking lot on west side of school

GREEN TRAILS ELEMENTARY

Replace eight rooftop exhaust fans
Replace one air intake damper and louver
Replace two hot water boilers and four pumps
Replace four rooftop HVAC units
Replace main electrical switchboard
Replace two roof sections
Replace two skylights with Solatubes

HANNA WOODS ELEMENTARY

Replace main electrical switchboard
Replace one roof section and add Solatubes
Create individually securable classrooms by extending walls to underside of roof deck

HENRY ELEMENTARY

Replace five rooftop HVAC units
Replace four rooftop HVAC units and modify duct system
Install fire sprinklers in two-story wing at back of the building

HIGHCROFT RIDGE ELEMENTARY

Replace two rooftop HVAC units
Replace two main electrical switchboards
Replace three sidewalks

MASON RIDGE ELEMENTARY

Replace water boiler
Replace four rooftop exhaust fans
Remove 28 condensing units and 28 heating/cooling ventilators and replace with individual HVAC units for each classroom and provide screen wall for units facing Mason Rd.
Replace 10 roof sections
Replace exterior stairs leading to parking lot on north side of building
Install a natural gas service to the building

MCKELVEY ELEMENTARY

Replace rooftop HVAC unit
Replace paved play area north of building
Replace four wood retaining walls on north, south and east side of building

OAK BROOK ELEMENTARY

Replace rooftop HVAC unit
Replace four electrical transformers
Replace kindergarten paved play area north of building
Replace four wood retaining walls on west and east side of the building site
Replace 10 sidewalks
Renovate nurse's office/health area

PIERREMONT ELEMENTARY

Replace 10 rooftop HVAC units
Replace three roof sections

RIVER BEND ELEMENTARY

Replace main electrical switchboard
Replace electrical panelboard
Replace, reconfigure and expand parking lot
Replace paved pad on north side of building
Replace three wood retaining walls on north and west sides of the building
Replace three sidewalks

ROSS ELEMENTARY

Replace four rooftop HVAC units
Replace nine rooftop exhaust fans
Replace 15 skylights
Replace driveway along north side of building
Replace exterior ramp leading from playground to upper field
Replace exterior ramps leading from cafeteria to handicap parking spaces
Replace exterior stairs leading from playground to upper field
Replace seven sidewalks

SHENANDOAH VALLEY ELEMENTARY

Replace one electrical transformer
Replace 15 roof sections
Paint metal roof
Replace main driveway and parking lot in front of school
Replace two sidewalks

SORRENTO SPRINGS ELEMENTARY

Replace 12 roof sections
Replace main parking lot and driveways in front of building
Replace driveway along south side of building

WREN HOLLOW ELEMENTARY

Replace one electrical transformer
Replace main water service
Replace driveway behind building
Replace two exterior stairs
Replace wood retaining walls on the north side of the building
Create individually securable classrooms by extending walls to ceiling, installing doors on classrooms including necessary modifications to HVAC and lighting systems

CENTRAL MIDDLE

Replace six rooftop HVAC units
Replace three rooftop HVAC units and modify duct system
Add three hot water boilers and three pumps
Replace one electric unit heater
Replace nine exhaust fans
Replace main electrical switchboard
Replace three electrical transformers
Replace 11 roof sections
Widen main drive at N. Woods Mill Rd. to add left turn lane
Replace circle drive and parking lot in front of school
Replace service driveway on west side of school
Replace wood retaining wall on the northwest side of school
Replace one sidewalk
Add secure vestibules at main entrance with double-entry doors

NORTHEAST MIDDLE

Replace four hot water boilers and two pumps
Replace five rooftop HVAC units
Install fire sprinklers in the 1994 addition to complete building sprinkler system
Renovate nurse's office/health area
Add secure vestibule at main entrance with double-entry doors
Replace exterior stairs leading to northwest entrance
Replace four sidewalks

SOUTH MIDDLE

Replace HVAC chiller
Replace two water pumps
Replace three rooftop exhaust fans
Replace three rooftop HVAC units
Remove three remote condensing units
Remove four radiant unit heaters
Replace natural gas service
Replace domestic hot water boiler
Replace five roof sections
Replace main driveway leading to school and parking lot
Replace exterior stairs leading to east side of school, leading to south side of school, leading to west side of school
Replace 11 sidewalks
Remove two sidewalks
Addition and renovations for classrooms and Student Services with necessary modifications to parking lots and drives
Add secure vestibule at main entrance with double-entry doors

SOUTHWEST MIDDLE

Replace 19 rooftop exhaust fans
Replace 20 rooftop HVAC units
Replace eight roof sections
Replace 24 skylights with Solatubes
Replace nine skylights
Add secure vestibule at main entrance with double-entry doors
Replace main drive, circle drive in front of school, and main parking lot

WEST MIDDLE

Replace three rooftop exhaust fans
Replace one rooftop HVAC unit
Replace 15 roof sections
Replace south driveway leading to paved play area and driveway leading to south service entrance
Replace and modify south paved play area
Replace concrete retaining wall west of school
Replace wood retaining walls north and west of school
Replace exterior ramps leading to soccer field, leading to south entrance, leading to and from west entrance
Replace two sidewalks
Add canopy to cover sidewalk leading from door to cafeteria
Add walls to enclose library including necessary HVAC modifications
Add secure vestibule at main entrance with double-entry doors

CENTRAL HIGH

Replace one interior HVAC unit
Replace seven rooftop HVAC units and modify duct system
Replace seven rooftop HVAC units
Replace pool filtration system
Replace seven roof sections
Replace north parking lot
Replace one sidewalk
Add secure vestibule at main entrance with double-entry doors

FERN RIDGE HIGH

Replace one rooftop HVAC unit
Replace four roof sections
Replace main electrical switchboard
Replace electrical distribution board
Renovate dual electrical service entrances into one service entrance
Install additional electrical circuits to increase access to power in classrooms
Replace ceilings and lighting in selected rooms
Add secure vestibule at main entrance with double-entry doors
Construct addition at main entry for displaced administration area
Renovate science classroom
Renovate existing administration area into two counselor offices
Renovate nurse's office/health area

NORTH HIGH

Replace pool filtration tank
Replace three electrical panelboards
Replace five electrical transformers
Replace stadium field lighting
Replace exterior stairs leading to north side of building, leading to west side of building from west parking lot and leading to track
Install addition for FACS and part of SSD
Renovate existing FACS into main administrative and reception area
Install addition to the west courtyard for new main entry and secure reception area which will include a new elevator connecting the lower level drama area, main floor and the second floor
Connect north and west parking lots

SOUTH HIGH

Replace two interior HVAC units and modify duct system to provide air conditioning for Gym C
Replace pool filtration system
Replace emergency electrical generator
Replace five main electrical switchboards
Replace nine electrical panelboards
Replace three electrical transformers
Replace two roof sections
Replace driveway leading from south parking lot up to the bridge
Replace exterior two sets of stairs leading to south entrance of school and two sets leading to east entrance of school
Replace two sidewalks
Replace bleacher seats in main gym
Add secure vestibule at main entrance with double-entry doors

WEST HIGH

Replace three rooftop HVAC units
Replace seven interior HVAC units and modify duct system
Replace two chillers
Replace cooling tower
Replace two chilled water pumps
Replace pool dehumidification unit
Replace one condensing unit
Replace four main electrical switchboards
Replace two electrical panelboards
Replace 16 electrical transformers
Replace one roof section
Renovate fine arts area
Replace paved loading area east of school
Replace exterior stairs leading to south side of school, north side of school leading to and from east side of school
Renovate locker bay area on 3rd floor to construct additional classrooms
Add secure vestibule at main entrance with double-entry doors

ADMINISTRATION, OPERATIONS, GROUNDS, INSTRUCTIONAL SERVICES CENTER, TRANSPORTATION

Replace one HVAC unit (Administration)
Replace wood retaining wall on the south side of the building (Administration)
Replace exterior stairs leading to main entrance from parking lot (Administration)
Replace sidewalk leading to main entrance of building (Administration)
Replace sidewalk leading to south area of building (Administration)
Replace three HVAC units (Operations)
Replace one electrical panelboard (Grounds)
Replace 13 HVAC units (ISC)
Replace one main electrical switchboard (ISC)
Replace one electrical panelboard (ISC)
Replace one electrical transformer (ISC)
Renovation of south wing including asbestos abatement and new HVAC system with modified duct system (ISC)
Replace main parking lot in front of building and driveway leading to secondary lot (ISC)
Replace exterior ramp leading to sidewalk west of building (ISC)
Replace exterior stairs leading to sidewalk in front of building (ISC)
Replace five sidewalks (ISC)
Renovate ISC to be a primary center for McKelvey including HVAC plumbing and electrical as required, to provide 17 classrooms, plus three special instruction, music and art classrooms (ISC)
Replace two HVAC units (Transportation)
Replace one lighting panelboard (Transportation)
Replace one roof section (Transportation)
Replace exterior stairs connecting southwest bus lots (Transportation)

ACROSS THE DISTRICT

Ongoing ADA accessibility projects to improve accessibility for individuals with disabilities
Ongoing replacement of damaged or failing interior and exterior doors, frames and hardware to meet code requirements
Masonry tuckpointing, exterior joint caulking, sealing plaster at Barretts, Bellerive, Henry, Mason Ridge, South Middle, North High and Administration
Ongoing replacement of broken, damaged or uninsulated windows
Ongoing replacement of worn floor coverings
Replacement of worn stadium athletic fields and resurface worn running tracks at high schools
Ongoing replacement of wood gym floors and bleachers
Renovate libraries at all five middle schools
Complete keying system security upgrade to replace door hardware on non-classroom rooms that can be locked from inside
Ongoing installment of future instructional technology needs for classrooms such as audio/visual equipment
Double the amount of security cameras at each elementary school to expand coverage
Ongoing restroom renovations
Sustainability project allowance for energy reduction, energy generation, stormwater runoff reduction and reduced mowing/irrigation
Replace current analog phone system with a digital network system
Add intruder-resistant safety film to identified secondary entrances and windows

FOR MORE INFORMATION
Please visit ParkwaySchools.net

class acts

Four Time State Singles Champion

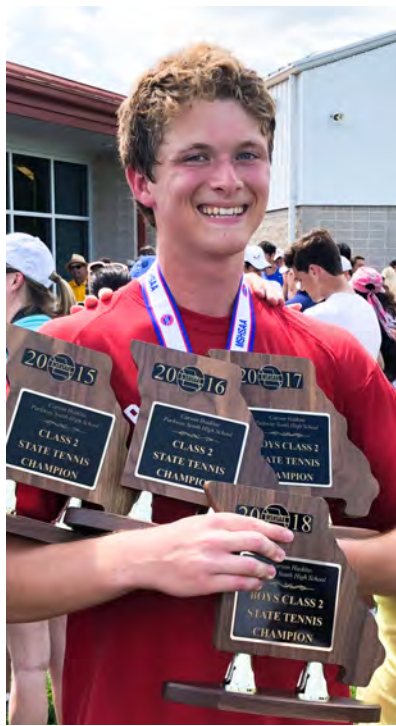

Last spring, then senior Carson Haskins became Missouri's class 2 high-school state tennis champion. This was Carson's fourth consecutive state title, a feat that has not occurred in 30 years! He went 94-0 never losing a set during his entire high school career. Upon his win, he ascended to the #1 ranking nationally for all boys 18 or younger.

Haskins was named Post-Dispatch All-Metro boys tennis player of the year. He now attends Indiana University participating in its men's tennis program.

Exemplary Principals



*Tori Cain Ed.D.
North High Principal*

Tori Cain, Ed.D., principal of North High, was named Exemplary New Principal of the Year by the St. Louis Association of Secondary School Principals.

Cain has been the principal at North High since 2017.

Kim Cohen, principal of McKelvey Elementary, was named the St. Louis region's Principal of the Year by the Missouri Association of Elementary School Principals.

Cohen has been the principal at McKelvey Elementary since 2010. Under Cohen's leadership, McKelvey Elementary has been named a Blue Ribbon School, National School of Character and a Green Ribbon School.



*Kim Cohen Ed.D.
McKelvey Elementary Principal*

Stepping up to Opportunity



Parkway Step Team

Last March, the Parkway Step team competed in the 10th Annual Spring Showdown in Virginia Beach. The middle school team placed second and the high school team placed first in their division. The high-school steppers also received the overall highest score, making them the grand champions.

Soaring Financial Leadership



The Association of School Business Officials International selected Patricia Bedborough, chief financial officer, as a recipient of its 2018 Distinguished Eagle Award.

Bedborough's award highlighted a zero-based budgeting process and reorganization of district operations. She has also led sustainability efforts, established a sports marketing initiative, forged new community partnerships and established employee health clinics. With more than 15 years of school financial experience, she is a recognized leader among her peers regionally and statewide for strong fiscal management and resource management to support all students.

KEEPING OUR STUDENTS SAFE

CURRENT SAFETY FEATURES



24/7 security department & safety tip line



Locks on every classroom door



Secure visitor management with buzz-in systems



Intruder-resistant safety film on main entry doors

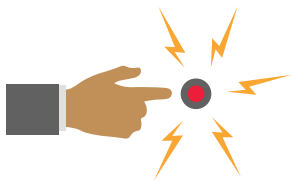

Panic buttons in every classroom



19 student safety drills a year & intruder training for staff



10 dedicated school resource police officers & 1200+ security cameras



Counselors & Behavioral Specialists on staff, character education invested in curriculum

NEW SAFETY FEATURES



Intruder-resistant safety film on secondary entrances and windows*

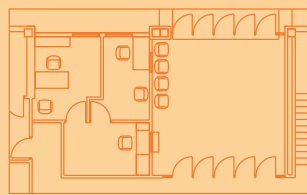

Double-entry security vestibules at all schools*



Enhanced visitor management system with ID checks



Walls extended to ceiling in classrooms for enhanced lockdown security*

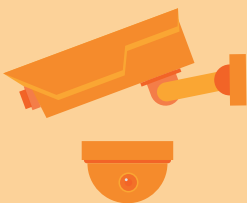

Double the number of elementary security cameras*



New locks on all remaining school doors*



More behavioral specialists to address student emotional needs

*** PROPOSED PROJECTS
PENDING APPROVAL
OF PROP S
ZERO TAX RATE INCREASE
BOND ISSUE**

Parkway's National Schools of Character



ast year, Parkway Schools was recognized as a National District of Character by Character.org. This year, Central Middle and the Early Childhood Center were named National Schools of Character and Ross Elementary was renewed as a National School of Character. Ross was the first Parkway school to receive the award in 2012. Character.org and its state affiliates recognize schools and districts that dedicate focus on character development programs and a positive impact on academic achievement, student behavior, school climate and their communities.

Parkway now has 11 National Schools of Character, including Carman Trails Elementary, Green Trails Elementary, Oak Brook Elementary, McKelvey Elementary, Craig Elementary, Barretts Elementary, Northeast Middle and Southwest Middle.



Promising Character Education Practices

Parkway Schools received 12 Promising Practice awards from Character.org in 2018. The organization awarded 258 Promising Practices to schools, districts and youth-serving organizations internationally. The Promising Practices program highlights what's working in classrooms across the world when it comes to character education. The program is simple in scope and recognizes many wonderful ideas from passionate teachers who are making a real difference in the lives of their students.

Central High

School-Wide Day of Service

Students and staff are encouraged to volunteer at the school's annual Special Olympics event, various off campus locations or engage in on-campus service learning.

Hanna Woods Elementary

Annual Home Visits Program

Every family receives a yearly home visit by teachers and staff in order to welcome them to the new school year and begin building a positive relationship.

Taste of Hanna Cultural Event

Every year, Hanna Woods plans an event called "Taste of Hanna" to showcase food, entertainment, and a marketplace that reflects the culture and diversity of its families and community.

Staff Community Service Day

Staff members make time for service projects in the Hanna Woods community while attending back to school meetings.

Highcroft Ridge Elementary

Learning Through Leadership

Fifth-grade students helped fourth-grade students learn how they could all support people impacted by natural disasters this year.

Mason Ridge Elementary

Choice Professional Development

Staff participated in monthly choice professional development centered around greatness, legacy and innovation.

McKelvey Elementary

Mindfulness

After spending a year learning about trauma-informed classrooms, McKelvey's school community has implemented strategies designed to increase mindfulness among students and staff, as well as yoga into classrooms.

Parkway Schools

Restorative Practices Academy

Parkway's approach to restorative practices is to provide development for teachers about the use of circles to proactively build community, teach curriculum, and ideally feel empowered to repair harm.

Pierremont Elementary

Bring Character to Life: Service Learning Projects

Pierremont is bringing character education to life in tangible, meaningful ways; buddy classes are designing and implementing service learning projects that engage the entire community.

River Bend Elementary

Window and Mirror - Diversity in our Community

In order to better understand diversity, the structure of being able to relate to others in one's community and being able to see one's self in one's community has been embedded in its school culture.

Ross Elementary

Character Journals

Using Google Classroom, students engage, reflect, and evaluate character-driven questions and scenarios in a daily character journal.

West High

Environmental Engineering Students Come Together for Hurricane Maria Victims

Students in the Honors Environmental Engineering class staged a benefit concert for victims of Hurricane Maria in Puerto Rico after studying how a lack of water impacts people around the world.



455 N. Woods Mill Rd.
Chesterfield, MO 63017
ParkwaySchools.net

NONPROFIT ORG.
U.S. POSTAGE
PAID
St. Louis, MO
Permit No. 2239

ECRWSS POSTAL CUSTOMER

Please Note: The Parkway School District Board of Education is committed to maintaining an educational environment that is free from discrimination and harassment in admission or access to, or treatment in, its programs, services, activities and facilities. In accordance with law, the district strictly prohibits discrimination and harassment against students on the basis of race, color, religion, sex, national origin, ancestry, disability, age, genetic information or any other characteristic protected by law.

For inquiries about the nondiscrimination policy, call (314) 215-8100.



WHAT'S INSIDE



- 1 Science: Growing Beyond the Basics
- 2 High Schools Ranked Top in Missouri
- 3 Forbes Magazine Recognizes Parkway
- 4 One School, 16 Championships
- 5-8 Zero Tax Increase Bond Information
- 9 Undefeated Four-Time State Champion
- 10 How We're Keeping Our Students Safe
- 11 National Schools of Character